

Midi Bi-Minder™ Installation Instructions

Follow the guidelines as shown in the installation section of this manual and see below for further instruction.



Important Note: Please ensure a concrete pad, 1610mm x 1350mm (200mm deep), is prepared prior to delivery. Glasdon strongly recommends the shelter is installed, using the fixings supplied, as soon as the shelter is delivered.



KIT CONTENTS

ITEM 1 Cover Cap Top	x5
ITEM 2 Heavy Duty Anchor Bolt M10x100mm	x5
ITEM 3 Shakeproof Washer	x5
ITEM 4 Stainless Steel Washer M10x20mm	x5
ITEM 5 Cover Cap Base	x5
ITEM 6 Stainless Steel Washer M10x35x1.5mm	x5

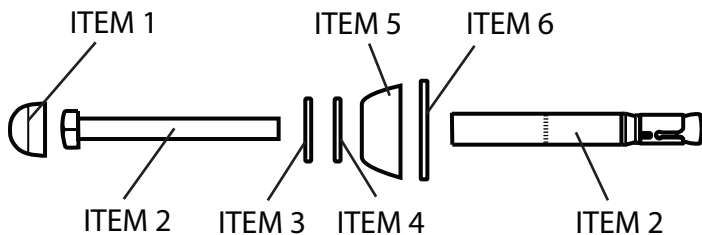

TOOLS/ITEMS REQUIRED

- 17mm Socket Wrench (torque 30Nm)
- Drill with Ø12mm masonry bit.
- Concrete base (as below)

Base to be minimum C20/25 grade concrete on well consolidated hardcore using Ordinary Portland Cement and Aggregates in accordance with BS:882.

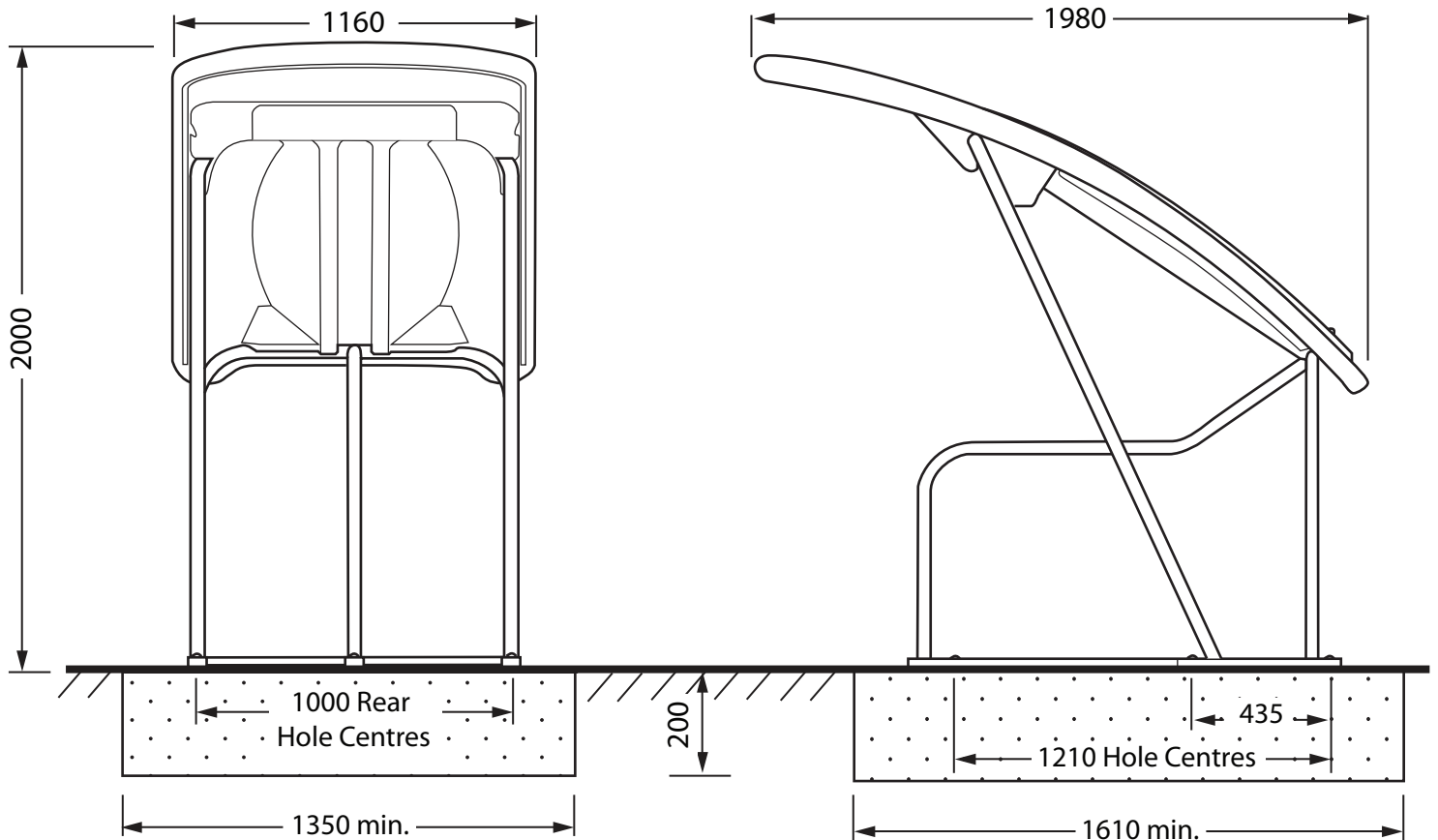

The concrete foundation pad must be at least 1350mm x 1610mm to **ensure there is a minimum of 100mm between each fixing and the edge of the concrete**. The recommended depth of the concrete is 200mm.

- Position the shelter and mark the ground through all 5 fixing holes.
- Slide the shelter to the side and drill the marked points, now reposition the shelter and using the fixings provided (see above for how these are assembled) place into the drilled holes and loosely tighten using a 17mm socket wrench.
- Check the alignment of the shelter and that fixings are tightening correctly and then tighten fully to the recommended torque setting. Once secure push Item 1's into Item 5's to cover the heads of the fixings.